



SUR-GN2-182-2D



Optional Cylindrical lock



Digital controller

→ *Sanwich preparation unit with flexible configuration.*

### STANDARD FEATURES

- Insulation** CFC free Polyurethane foam injected under 500 tons of pressure to ensure uniformity and high structural strength.
- Finish** Tough, hygienic construction, stainless steel interior and exterior, zincalume steel top base and back.
- Door** Doors are self closing with easy replaceable magnetic gaskets.
- Refrigerator system** Mono-Block self contained refrigeration system, designed for easy service. System can be easily removed and replaces with a spare unit. Fitted with condensate evaporator, no drain connection required.
- Controller** Microprocessor controlled with digital display.
- Optional Extra**
  - Cutting Board
  - S/S Shelf
  - Cylindrical or plate lock
  - Caster wheel
  - GN 1/6 Pan

### TECHNICAL DATA

#### Refrigerated Models

Model number	SUR-GN2-1145	SUR-GN2-1830	SUR-GN2-2485
Dimension L x D x H (mm.)	1145 x 765 x 850	1830 x 765 x 850	2485 x 765 x 850
Capacity (ltr.)	235	480	721
Temperature range	2 °C to 5 °C		
Refrigerant	R 134 a		
Cooling capacity (Btu.)	735	1450	2068
Condensing unit (Hp.)	1/4	1/3	1/3
PVC. coated wire shelves	2 (GN 2/1)	4 (GN 2/1)	6 (GN 2/1)
Pan (Optional)	6 - GN 1/6 - 100 mm.	12 - GN 1/6 - 100 mm.	18 - GN 1/6 - 100 mm.
Power supply	220 V / 50 Hz / 1 Ph. (60 Hz models are available)		

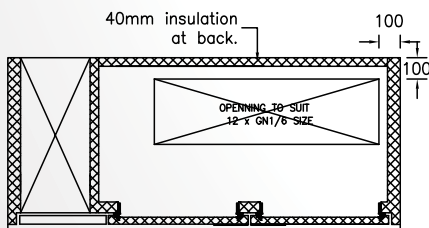

SECTION - TOP VIEW

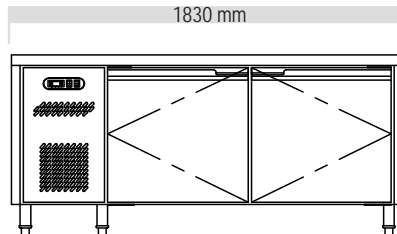

FRONT VIEW

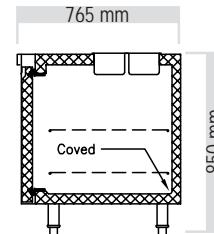

SECTION - RH VIEW



Scan me

